



Burma Close, Evesham, WR11 1GZ

**SHELDON  
BOSLEY  
KNIGHT**

LAND AND  
PROPERTY  
PROFESSIONALS

# Property Description

\*\*\*\*DETACHED FAMILY HOME  
OFFERED TO THE MARKET CHAIN  
FREE \*\*\*\*

This well-prestend FOUR bedroom property has been renovated in recent years and is located close to schools and amenities. The property comprises; entrance hall, kitchen, dining area and living room with open plan aspect, study, conservatory and w.c. The first floor comprises master bedroom with fitted wardrobes and en-suite, two further double bedrooms, single fourth bedroom and family bathroom. Externally, the property benefits from off street parking for two cars and rear garden with decking and lawned area.





# Key Features

- DETACHED FAMILY HOME
- FOUR BEDROOMS
- MODERN AND OPEN PLAN
- OVER 1300 SQ FT
- EPC RATING - D
- CHAIN FREE

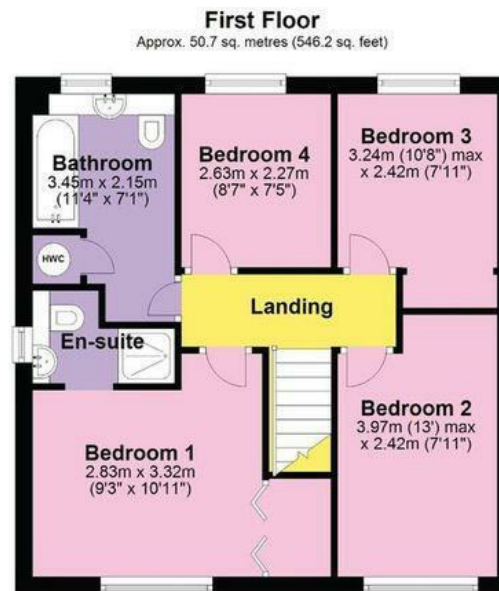

Total area: approx. 123.0 sq. metres (1323.8 sq. feet)

DISCLAIMER - Floor plans shown are for general guidance only. Whilst every attempt has been made to ensure that the floorplan measurements are as accurate as possible, they are for illustrative purposes only.

